



Kit 78681

Nissan L32/A35

Rear Application



INSTALLATION GUIDE

For maximum effectiveness and safety, please read these instructions completely before proceeding with installation.

Failure to read these instructions can result in an incorrect installation.

TABLE OF CONTENTS

A. Introduction	2
Notation Explanation	2
B. Important Safety Notices	2
C. Installation Diagram	3
Hardware List	3
D. Installing the Air Suspension	4
Removing the Stock Suspension	4
Installing the Kit Components	5
Routing the Air Lines	8
E. Before Operating	8
Setting the Ride Height	8
Torque Specifications	8
Suggested Driving Air Pressure	8
Maximum Air Pressure	8
Check for Binding	8
Installation Checklist	9
Damping Adjustment	9
Limited Warranty and Return Policy	9

A. Introduction

Air Lift Performance thanks you for purchasing the most complete, fully engineered high-performance air suspension made for the Nissan L32/A35. Read these installation instructions to correctly and safely set up the vehicle for a #lifeonair.

Air Lift assumes that the installer has the mechanical knowledge and ability to work on vehicle suspension systems and has basic tools necessary to complete a suspension replacement project. Special tools needed to complete the installation are noted on the *Installation Diagram* page.

Air Lift reserves the right to make changes and improvements to its products and publications at any time. For the latest version of this manual, contact Air Lift Performance at (800) 248-0892 or visit www.airliftperformance.com.

An Air Lift Performance air management system is highly recommended for this product. Learn more at air-lift.co/productlines.

NOTATION EXPLANATION

Hazard notations appear in various locations in this publication. Information which is highlighted by one of these notations must be observed to help minimize risk of personal injury or possible improper installation which may render the vehicle unsafe. Notes are used to help emphasize areas of procedural importance and provide helpful suggestions. The following definitions explain the use of these notations as they appear throughout this guide.



DANGER

INDICATES IMMEDIATE HAZARDS WHICH WILL RESULT IN SEVERE PERSONAL INJURY OR DEATH.



WARNING

INDICATES HAZARDS OR UNSAFE PRACTICES WHICH COULD RESULT IN SEVERE PERSONAL INJURY OR DEATH.



CAUTION

INDICATES HAZARDS OR UNSAFE PRACTICES WHICH COULD RESULT IN DAMAGE TO THE VEHICLE OR MINOR PERSONAL INJURY.

NOTE

Indicates a procedure, practice or hint which is important to highlight.

B. Important Safety Notices



WARNING

DO NOT INFLATE AIR SPRINGS WHILE OFF OF THE VEHICLE. DAMAGE TO ASSEMBLY MAY RESULT AND VOID WARRANTY.



CAUTION

DO NOT WELD TO OR MODIFY PERFORMANCE STRUTS/SHOCKS IN ANY WAY. DAMAGE TO UNIT MAY OCCUR AND WILL VOID WARRANTY.



WARNING

AFTER INSTALLATION, ENSURE ALL ORIGINAL EQUIPMENT VEHICLE SAFETY FEATURES ARE PROPERLY CALIBRATED BY A QUALIFIED TECHNICIAN. CHANGING VEHICLE HEIGHT MAY AFFECT FUNCTIONING OF SAFETY SENSORS AND CAMERAS.

C. Installation Diagram

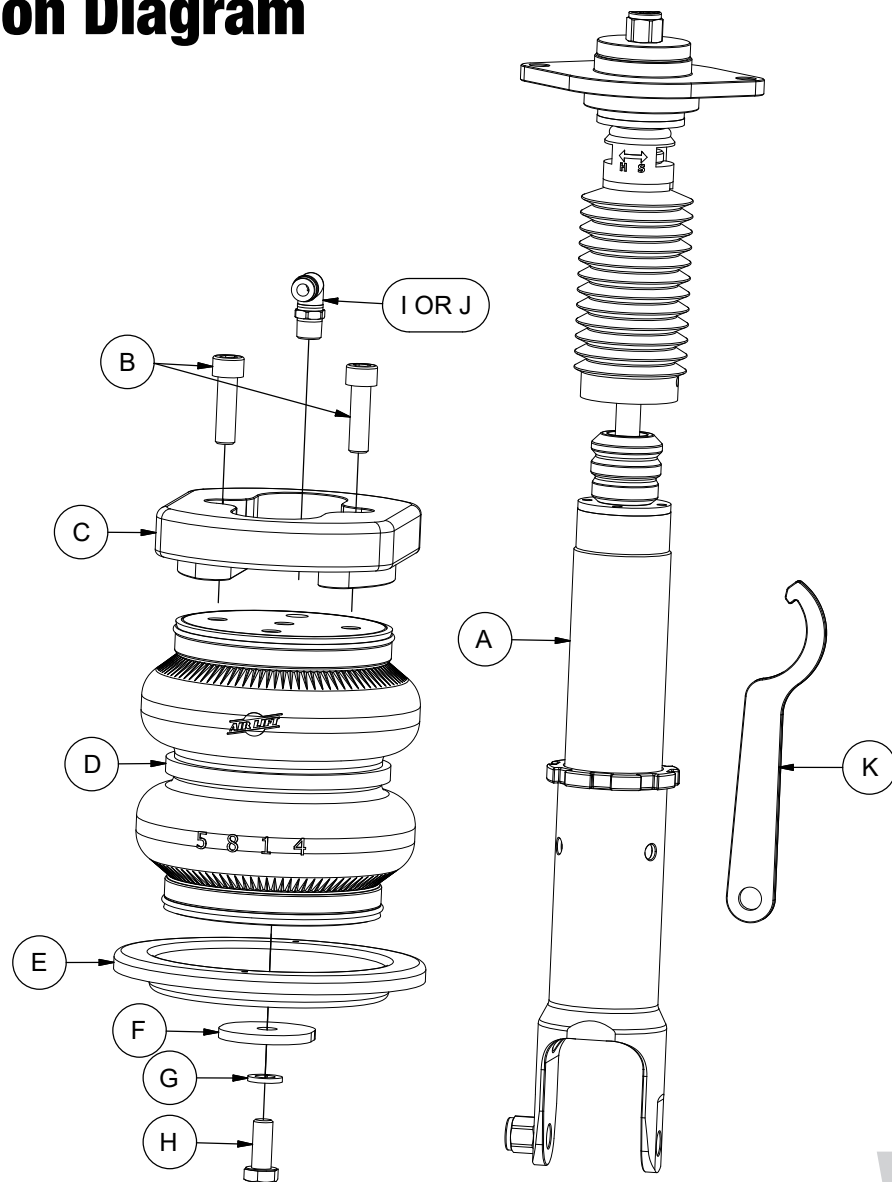

fig. C.1

HARDWARE LIST

Item	Part #	Description	Qty
A	26624	Rear shock.....	2
B	17518	M10-1.5 x 35 Socket head cap screw.....	4
C	13330	Upper spacer	2
D	58550	Air spring	2
E	11801	Roll plate.....	2
F	13312	Lower centering spacer.....	2
G	18628	M10 Split lock washer	2
H	17517	M10-1.5 x 25 Hex cap screw	2
I	21779	1/4" MNPT x 1/4" PTC Elbow	2
J*	21851	1/4" MNPT x 3/8" PTC Elbow	2
K	11289	M50 Spanner	1

*1/4" MNPT x 3/8" PTC fittings are NOT included in this kit, but are available as a special order.



Missing or damaged parts? Call Air Lift customer service at (800) 248-0892 for a replacement part.

D. Installing the Air Suspension

NOTE

See "Important Safety Notices" on page 2.

REMOVING THE STOCK SUSPENSION

1. Raise the vehicle and remove the wheel. Support the lower control arm with a jack (Figs. D.1 & D.2).



fig. D.1



fig. D.2

2. Remove lower control arm outer pivot bolt. Lower the jack slowly to release tension from the coil spring. Remove the coil spring from the vehicle (Figs. D.3-D.5).



fig. D.3



fig. D.4



fig. D.5

3. Raise the control arm into position with the rear knuckle and reinstall the outer pivot bolt. Do not torque the outer pivot bolt at this time.
4. Remove the lower shock mount bolt (Figs. D.6 & D.7).

fig. D.6



fig. D.7



5. Remove upper shock mount nuts and remove the shock from the vehicle. Do not discard the nuts (Fig. D.8).



fig. D.8

INSTALLING THE KIT COMPONENTS

1. Using the included centering spacer (F) as a template, mark and drill a 13/32" (.406") diameter hole in the lower control arm spring seat (Fig. D.9).

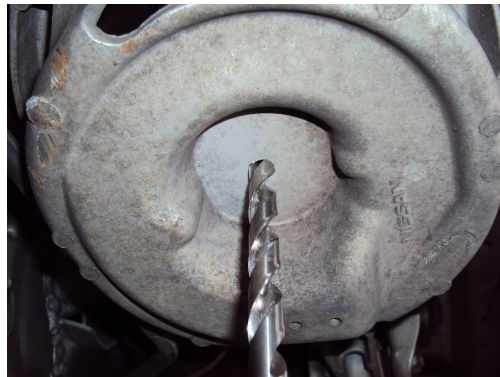

fig. D.9

2. Begin by applying thread sealant to the threads of the appropriate fitting (I or J). Tighten the fitting to the air spring upper end cap 1 3/4 turns beyond hand-tight (Fig. D.10).

*fig. D.10*

3. Install upper air spring spacer (C) with (2) socket head cap screws (B) (Fig. D.11). Torque the screws to 46Nm (34 lb.-ft.).

*fig. D.11*

4. Install the air spring assembly in the lower control arm. The air line should be routed and inserted into the fitting at this time (Fig. D.12).



Air line pointed
rearward for ease
of installation

fig. D.12

5. Using the hex cap screw (H), split lock washer (G), and lower centering spacer (F), bolt the air spring assembly to the lower control arm (Fig. D.13). Torque the bolt to 46Nm (34 lb.-ft.).



fig. D.13

6. Insert the Air Lift Performance rear shock (A) mounting into the chassis and install the previously removed nuts (Fig. D.14). Torque the nuts to 25Nm (18 lb.-ft.).

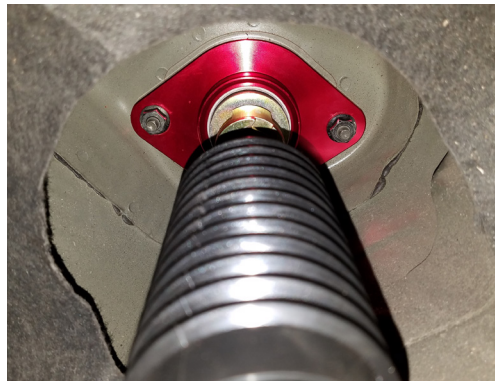

fig. D.14

7. Raise the jack until the lower mount of the Air Lift Performance shock is aligned with the bushing of the rear suspension knuckle. Install the lower shock mount bolt with the nylon locking nut included with the Air Lift Performance shock (Figs. D.15 & D.16). Torque the bolt to 110Nm (81 lb.-ft.).



fig. D.15



fig. D.16

ROUTING THE AIR LINES

1. Fully compress the suspension using a jack. With the suspension compressed, review the best routing for the leader line that is clear of all suspension components and axle.
2. Routing should also allow for the suspension to extend without kinking or pulling the line tight or rubbing on other components. Following the brake line routing is often a good place to start. Check clearances to all other components.

WARNING

AFTER INSTALLATION, ENSURE ALL ORIGINAL EQUIPMENT VEHICLE SAFETY FEATURES ARE PROPERLY CALIBRATED BY A QUALIFIED TECHNICIAN. CHANGING VEHICLE HEIGHT MAY AFFECT FUNCTIONING OF SAFETY SENSORS AND CAMERAS.

E. Before Operating

SETTING THE RIDE HEIGHT

1. Refer to the User Guide supplied with this kit to set up the suspension.

Torque Specifications		
Location	Nm	lb.-ft.
Air spring upper spacer socket head screws	46	34
Centering spacer bolt	46	34
Upper shock mount nuts	25	18
Lower shock mount bolt	110	81
Lower control arm inner pivot bolt	169	125
Lower control arm outer pivot bolt	118	87
Rear wheel lugnuts	113	83

Table 1

Suggested Driving Air Pressure	Maximum Air Pressure
45-55 PSI (3.1-3.8BAR)	125 PSI (8.6BAR)
FAILURE TO MAINTAIN ADEQUATE MINIMUM PRESSURE (OR PRESSURE PROPORTIONAL TO LOAD) MAY RESULT IN EXCESSIVE BOTTOMING OUT AND WILL VOID THE WARRANTY.	

Table 2

CHECK FOR BINDING

CAUTION

MAKE SURE THE FRONT WHEELS ARE STRAIGHT WHEN DEFLATING AND REINFLATING AIR SPRINGS.

1. Inflate and deflate the system (do not exceed 125 PSI [8.6BAR]) to check for clearance or binding issues. With the air springs deflated, check clearances on everything so as not to pinch brake lines, vent tubes, etc. Clear lines if necessary.
2. Inflate the air springs to 75-90 PSI (5.2-6.2BAR) and check all connections for leaks.

INSTALLATION CHECKLIST

- ☐ **Clearance** — Inflate the air springs to 75-90 PSI (5.2-6.2BAR) and make sure there is at least 1/2" (13mm) clearance from anything that might rub against the air spring. This should be checked with the air spring fully inflated and fully deflated.
- ☐ **Leak** — Inflate the air springs to 75-90 PSI (5.2-6.2BAR) and check all connections for leaks. All leaks must be eliminated before the vehicle is road tested.
- ☐ **Heat** — Be sure there is sufficient clearance from heat sources, at least 6" (152mm) from air springs and air lines. If a heat shield was included in the kit, install it. If there is no heat shield, but one is required, call Air Lift customer service at **(800) 248-0892**.
- ☐ **Fastener** — Recheck all bolts for proper torque.
- ☐ **Road** — Inflate the air springs to recommended driving pressures (Table 2). Drive the vehicle 10 miles (16km) and recheck for clearance, loose fasteners and air leaks.
- ☐ **Operating instructions** — If professionally installed, the installer should review the operating instructions with the owner. Be sure to provide the owner with all paperwork that came with the kit.

DAMPING ADJUSTMENT

1. The dampers in this kit have 30 settings, or "clicks," of adjustable compression and rebound damping characteristics. Damping is changed through the damper rod using the supplied adjuster (Figs. E.1 & E.2) or a 3mm hex key (not included).
2. Turn the adjuster clockwise (H) and the damping settings are hardened, reducing oscillations and body motion. Turn the adjuster counterclockwise (S) and the damping is softened.
3. Each damper in this kit is preset to "-14 clicks." This means that the damper is adjusted 14 clicks away from full stiff, which starts at 0. Counting up from full stiff is the preferred method of keeping track of, or setting, damping. This setting was developed on a 2007 Nissan Altima.

For more information, refer to the User Guide.



fig. E.1



fig. E.2

Limited Warranty and Return Policy

Air Lift Company provides a 1-year limited warranty to the original purchaser of Air Lift Performance damper kits from the date of original purchase, that the products will be free from defects in workmanship and materials when used on vehicles as specified by Air Lift Company and under normal operating conditions, subject to the requirements and exclusions set forth in the full Limited Warranty and Return Policy that is available online at www.airliftperformance.com/warranty.

For additional warranty information contact Air Lift Company customer service.

Air Lift Company reserves the right to make changes and improvements to its products and publications at any time. For the latest version of this manual, contact Air Lift Company at **(800) 248-0892** or visit www.airliftperformance.com.

Need Help?

The Air Lift Company customer service department is open from 8 a.m. to 8 p.m. ET Monday through Friday. Call (800) 248-0892 or (517) 322-2144 for calls from outside the U.S. and Canada.



CONNECT BY SEARCHING FOR **AIR LIFT PERFORMANCE** #LIFEONAIR



Thank you for purchasing Air Lift Performance products!



Air Lift Performance • 2727 Snow Road • Lansing, MI 48917 or P.O. Box 80167 • Lansing, MI 48908-0167
Toll Free (800) 248-0892 • Local (517) 322-2144 • Fax (517) 322-0240 • www.airliftperformance.com

Printed in the USA
JJC-1019

California: ⚠️ WARNING: Cancer and Reproductive Harm – www.P65Warnings.ca.gov